

Polar Shades Interior Shade

Motorized
With Fascia

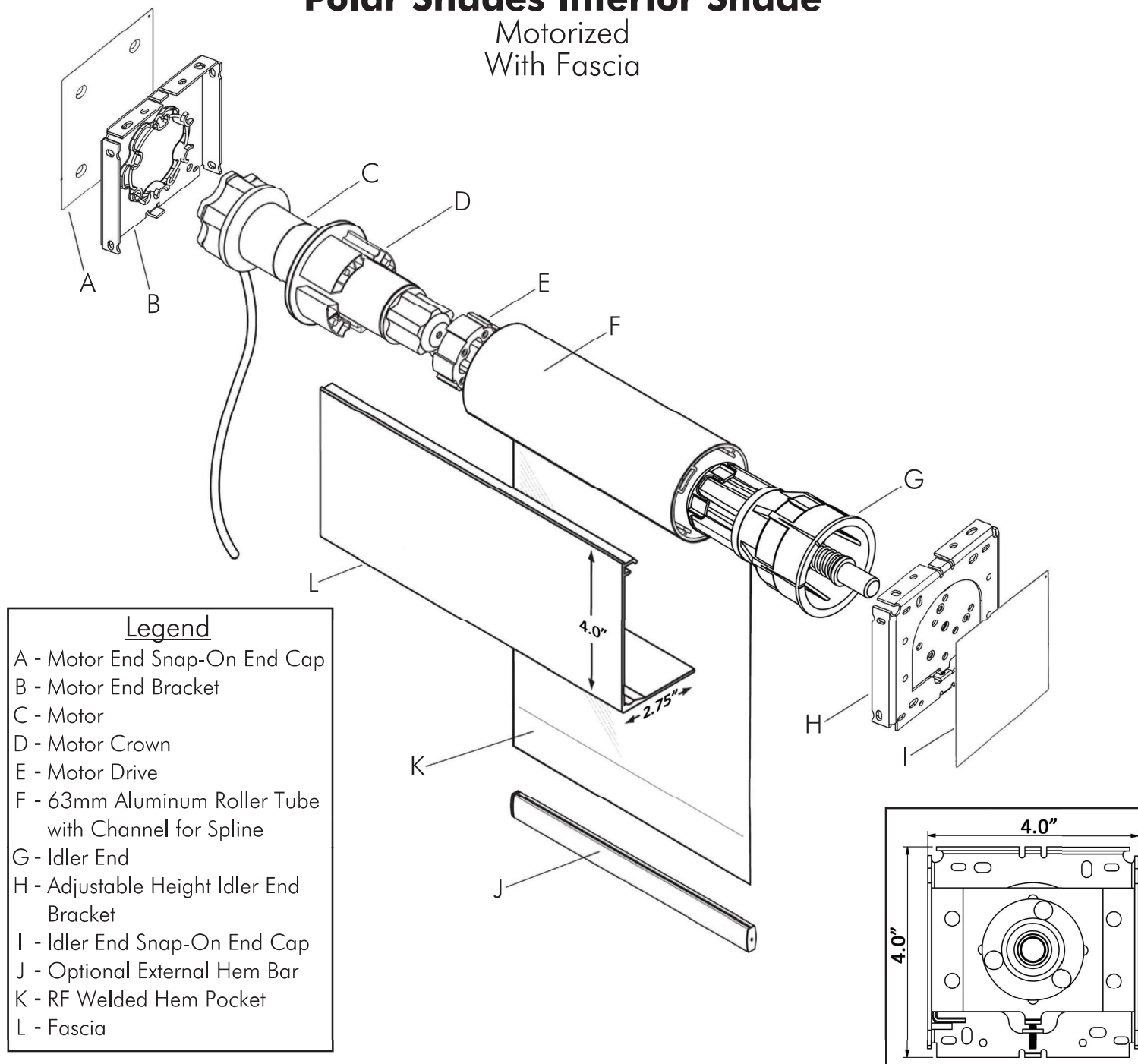

- ⚙ Line voltage AC motor raises and lowers the shade.
- ⚙ Motors come standard with a 10' pigtail. Additional lengths and plugs are available.
- ⚙ 63mm extruded aluminum roller tube is designed with groove for fabric band spline which is used for shades exceeding 120".
- ⚙ Standard adjustable idler end bracket allows shade to be leveled while in place.
- ⚙ Internal hem bar sealed in RF Welded Hem Pocket with optional External Hem Bar available.
- ⚙ 4.00" X 2.75" fascia available for AC motorized systems in white, ivory, anodized, bronze, or black.
- ⚙ Edge gap is 7/8" on the motor end and 7/8" on the idler end.
- ⚙ Precision bearings for quiet operation are standard.

Out with the old, In with the View!

877-260-6110

POLAR SHADES®
sun control

polarshade.com

5520 Stephanie Street • Las Vegas, NV 89122 • info@polarshade.com